

Rugged all-rounders for heavy-duty applications

- ASW »Stone« heavy-duty push off trailer
- »Stone-Master« heavy-duty tipper

**Fliegl push-off
technology**

tried-and-tested system



Wir sind Fliegl.



Website

www.fliegl-baukom.de

GB

»Made in Germany – made by Fliegl«

Quality from the off...



Paint preparation with shot blasting



Black Bull assembly



In-house switch cabinet assembly and programming of electronic controls



Modern paint shop – optimum surface protection for your new system



High-tech welding robots ensure maximum weldseam quality.



Production video

...with state-of-the-art production

Thanks to the new, ultra-modern plant in Mühl Dorf, even more customers can benefit from innovative and practical Fliegl solutions.

As well as Fliegl Bau- und Kommunaltechnik, the complex is also home to Fliegl Agrartechnik and Fliegl Dosiertechnik.

Approximately 350 employees work across the 30-hectare site of the company headquarters. The new plant boasts cutting-edge manufacturing facilities for the production of thermal push-off vehicles, water tankers, tippers and concrete mixing technology.



The sophisticated tube and sheet laser systems allow us to process even the most complex elements with maximum speed and precision.



Wir sind Fliegl.

»Stone Master« heavy-duty tipper – the master in its class



+ Chute over front cylinder (standard equipment)

+ Hydraulic rear panel with additional pendulum function

+ Extremely wide opening angle of hydr. rear panel

"Stone Master" heavy-duty dumper

In its development, Fliegl tapped into its extensive expertise in the construction sector, where the company's high-quality products have proven themselves time and again in the toughest applications.

Wide-track chassis for greater stability

Highly wear-resistant steel with 400-450 HB hardness

Type		Stone Master 252 tandem
Capacity, heaped (volumetric)	approx. m³	15 (12.5)
Permitted total weight acc. to StVO (depending on equipment)	up to kg	22,000
Body floor and side walls made from 6 mm highly wear-resistant steel HB 400-450		Standard
Body length	approx. mm	5,150
Hydraulic rear panel with additional pendulum function		Standard
High tipping force thanks to oversized front tipping cylinder with double-hose rapid lowering		Standard
Required oil volume	approx. l	36
Chute over front cylinder (excavator protection)		Standard
Traction bar, hydraulically sprung, height-adjustable		Standard
Axle (brake)	mm	410 x 180
Axle cross section	mm	150 x 150
Floating axle assembly with automatic load-dependent brake force regulator (ALB)		Standard
Wide-track chassis for maximum stability		Standard
Tyres (more information available on request)		385/65-R22.5 445/65-R22.5 600/55-R26.5 650/55-R26.5

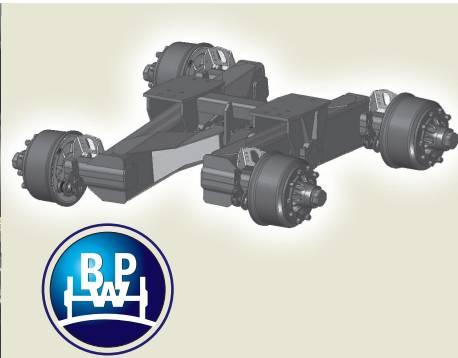
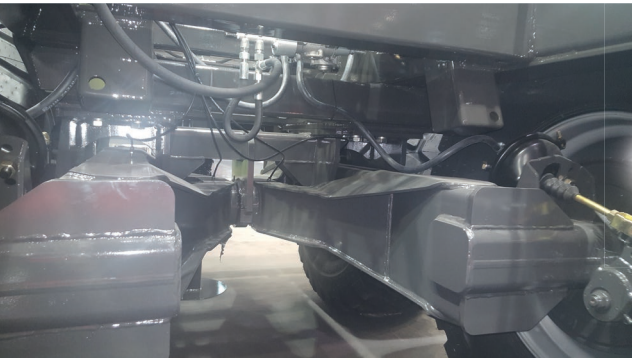

- + Hydraulic drawbar suspension (standard)
- + Hydraulic height adjustment (standard)
- + No knocks and jolts like with rubber blocks
- + Traction bar with top/bottom reinforcement

- + Bottom reinforcement of body → significantly more durable with rubble and rock
- + Very low centre of gravity: - Beneficial when driving and loading

+ Extremely high tipping angle

+ ORIGINAL BPW floating assembly

+ With central lubrication strip

+ Wide-track chassis, robust and highly torsion-resistant

+ With automatic load-dependent brake force regulator (ALB) (standard) → instead of the manual control offered by many competitors



»Stone Master« heavy-duty tipper – the master in its class



TMK Stone TANDEM HEAVY-DUTY DUMPERS
The transport experts for earth-moving and gravel transport



TMK 130 S



		TMK 130 S	TMK 200 S
Perm. total weight	kg	13,000 t	20,000 t
Bridge	mm	4,500 x 2,300 x 500	5,000 x 2,300 x 900
Tyres		15/70-18 355/60-R18 445/45-R19.5	445/45-R19.5 600/50-R22.5
Gravel flap, hydr. folding		Standard	-
Hydraulic rear panel (upward folding)		-	Standard
Body floor made from highly wear-resistant steel 400- 450 HB		Standard	Standard
Lashing lugs		Standard	Standard

- + Wide-track chassis for greater stability
- + Radial tyres and BPW axles
- + Hydraulic drawbar suspension
- + Body made ENTIRELY of 6 mm highly wear-resistant steel with min. 400-450 HB (body floor and side walls)



SHOULDER PAVER

»Black Bull« heavy-duty push-off trailer



- + Quick and efficient creation and maintenance of verges
- + Performance of approx. 5 km/day* with just one operator, incl. compaction

* depending on installation conditions

ASW 367 Black Bull with hydraulic chassis

Cover systems for Black Bull



* Side impact protection optional



Watch video

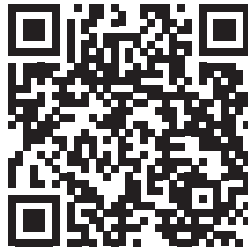

Watch video

ASW Stone – pushing instead of tipping (over)



ASW 367 Black Bull in use on construction site*



ASW 252 Black Bull, hydraulic



ASW 367 Black Bull, air*



ASW 252 Black Bull, floating



ASW 248 Big Run

- + Drawbar with hydr. suspension (standard)
MAXIMUM comfort = first-class ride comfort
- + No knocks and jolts like with rubber blocks
- + Hydr. height adjustment (standard)

- + Very low oil requirement:
only approx. 14/17 l (tandem),
approx. 27 l (tridem)
consumed oil volume from tank
→ No on-board hydraulics with drive shaft required
→ Reduced wear and minimised damage

Complete emptying,
even of highly viscous
material (loam, wet
ground, clay etc.)
No manual cleaning or
scraping of the tipper
bridge



Tilting



Pushing

* Side impact protection optional



Safe unloading even in extreme
situations

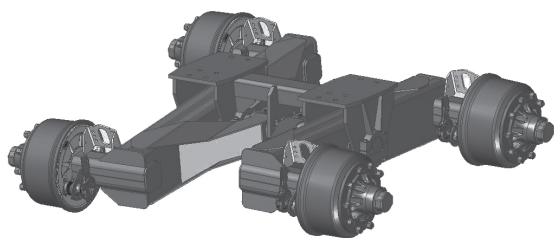

Floating assembly (optional) with
central lubrication and automatic load-
dependent brake force regulator (ALB)

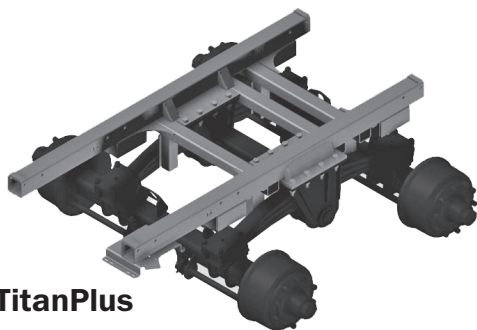

TitanPlus

Enjoy the following benefits:

- Maximum stability thanks to ideal centre of gravity
- Safe unloading, even on inclines
- Straightforward push-off in low buildings, tunnels or underground
- Safe handling, even in extreme driving situations
- Precision unloading possible (e.g. in road construction, soil stabilisation, etc.)
- Highly wear-resistant steel with 400-450 HB hardness withstands even the toughest conditions

The original, tried-and-tested Fliegl
push-off system

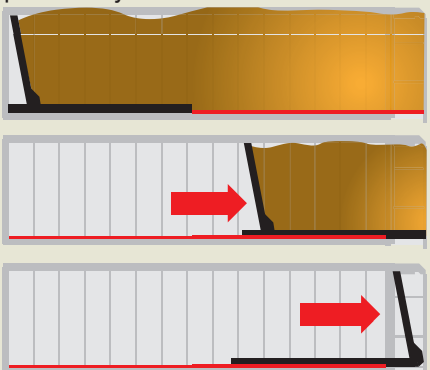



Type		ASW 248 Stone (Big Run)
Capacity, heaped (volumetric)	approx. m ³	14.2 (11.7)
Total weight acc. to StVZO (depending on equipment)	up to kg	22,000
Body length incl. 500 mm high-capacity rear panel	mm	5,300 (4,800 + 500)
Internal body width	mm	2,380
Lateral body height	mm	1,100
Required/consumed oil volume from tank (oil volume for push-off process)	approx. l	Only 14 (36)
No. of brake axles		2
Axle (brake)	mm	410 x 180
Axle cross section	mm	150 x 150
Mechanically adjustable axle assembly		Standard
»TITAN plus« axle assembly		Standard
Floating axle assembly		Optional
Tyres 650/55-R26.5*		Standard
Tyres 600/55-R26.5		Optional
Traction bar, hydraulically sprung / height-adjustable		Standard
Automatic load-dependent brake force regulator (ALB)		Standard
Max. speed	km/h	40

* Other tyres available on request

Subject to technical change

Some images show special equipment

Type		ASW 252 Black Bull, floating	ASW 252 Black Bull, hydraulic	ASW 367 Black Bull, air	ASW 367 Black Bull, hydraulic
Capacity, slightly heaped (volumetric)	approx. m ³	16 (13.6)	16 (13.6)	19.5 (17.7)	19.5 (17.7)
Total weight acc. to StVZO (depending on equipment)	up to kg	22,000	24,000	33,000	31,000
Body length	mm	5,230	5,230	6,730	6,730
Internal body width	mm	2,370	2,370	2,370	2,370
Lateral body height	mm	1,150	1,150	1,150	1,150
Required/consumed oil volume from tank (oil volume for push-off process)	approx. l	Only 17 (56)	Only 17 (56)	Only 27 (85) ✓	Only 27 (85) ✓
No. of brake axles		2	2	3	3
Axle (brake)	mm	410 x 180	410 x 180	410 x 180	410 x 180
Axle cross section	mm	150 x 150	150 x 150	150 x 150	150 x 150
Forced steering		/	Standard 2nd axle	Standard 1st and 3rd axle	Standard 1st and 3rd axle
Floating assembly / air suspension		Floating standard	/	Air standard	/
Hydraulic suspension		/	Standard	/	Standard
Tyres 650/55-R26.5		Standard	Standard	Standard	Standard
Tyres 600/60-R30.5		/	Optional	Optional	/
Traction bar, hydraulically sprung / height-adjustable (reinforced V-drawbar)		Standard	Standard	Standard	Standard
Automatic load-dependent brake force regulator (ALB)		Standard	Standard	Standard	Standard
Max. speed	km/h	40	40	40	40



- No on-board hydraulics with drive shaft required
- Reduced wear and minimised damage
- Significantly better construction site capability



Fliegl Bau- und Kommunaltechnik GmbH
 Bürgermeister-Boch-Str. 1 · 84453 Mühldorf · Germany
 Tel.: +49 (0)8631 307 382 · Fax: +49 (0)8631 307-553
 E-mail: baukom@fliegl.com

www.fliegl-baukom.de

Your qualified local contact: